

Drawers

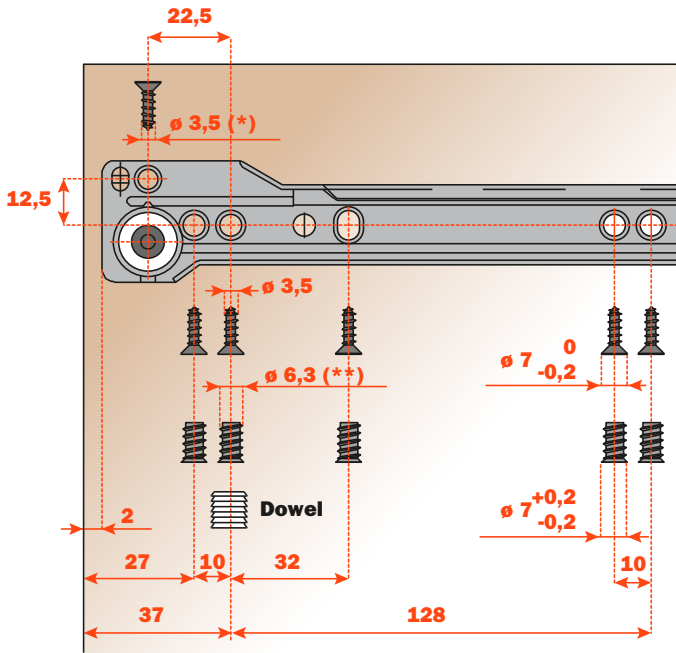

Fixing runner on cabinet side



Art. 900 - 8000 - Drilling positions for runner on cabinet side. Assembly with screws.

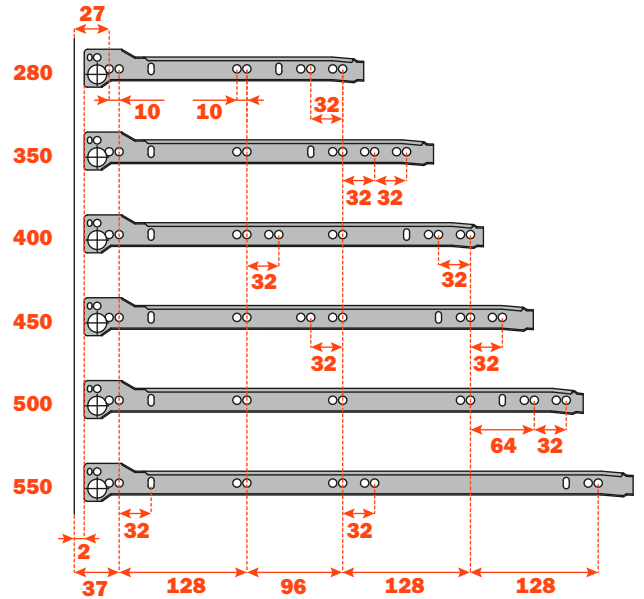

(*) Advised screw

(**) EUROSREW for pre-drilling $\phi 5$

Art. 900 - 8000 - Positions of 2 dowels on runner for cabinet side. Knock-in assembly.

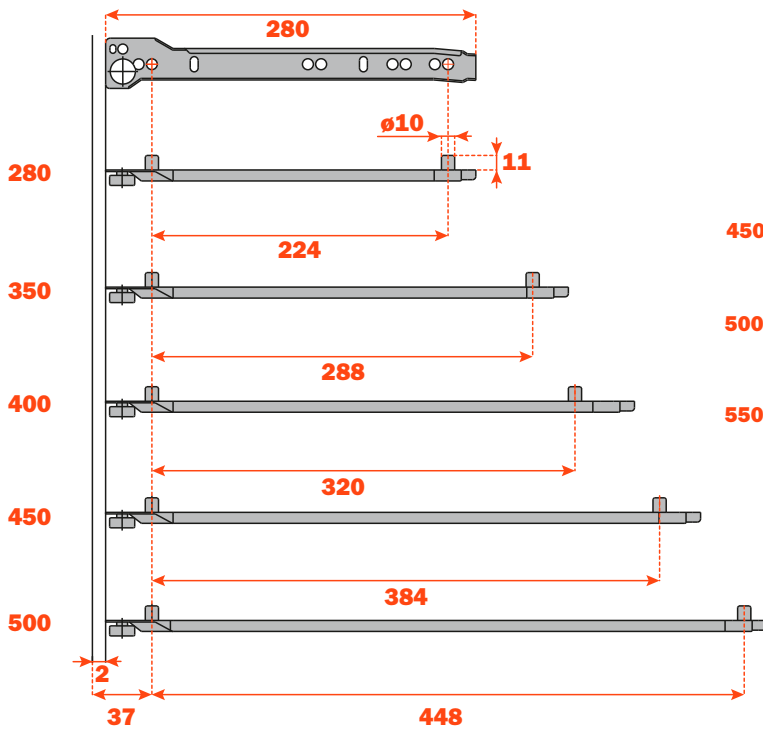

Art. 900 - 8000 - Positions of 3 dowels on runner for cabinet side. Knock-in assembly.

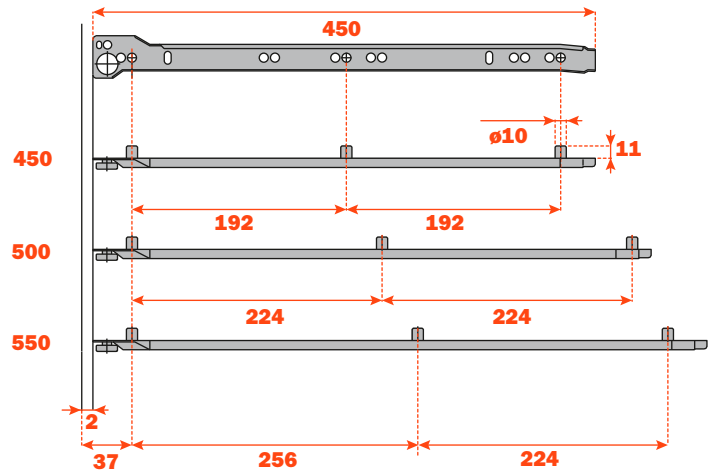

Art. 900 - 8000 - Drawer setting: abbreviations

Chest of drawers

LN = Nominal runner length

PM = Depth of the cabinet

X = Internal width of the cabinet

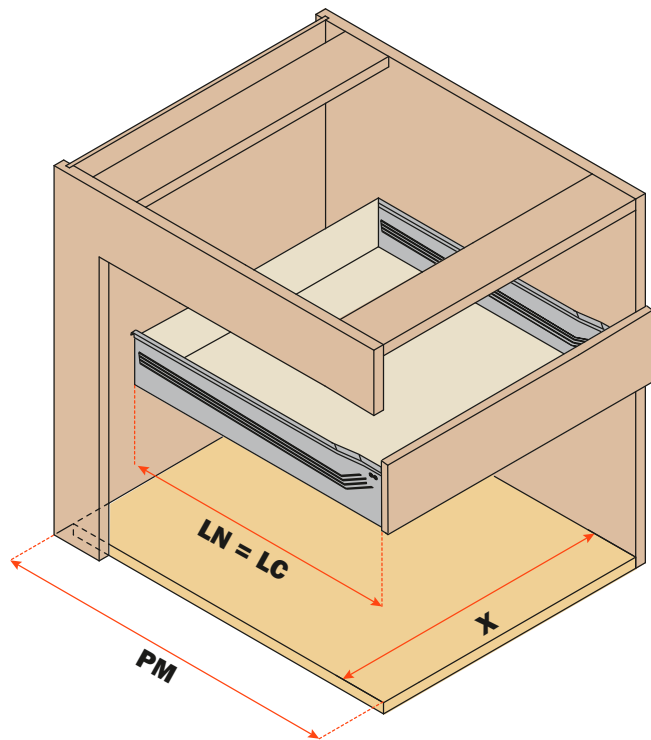

Drawer dimensions

LC = Drawer length

X - 32 = Internal width of the drawer

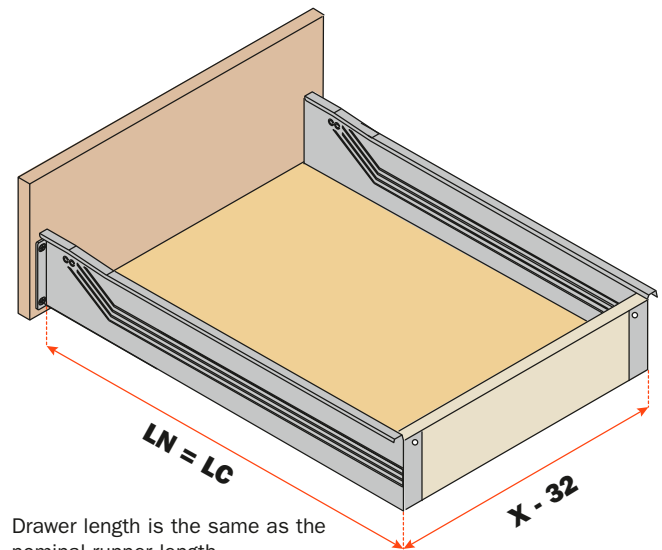

Drawer length is the same as the nominal runner length

The internal width of the drawer is 32 mm shorter than the internal width of the cabinet

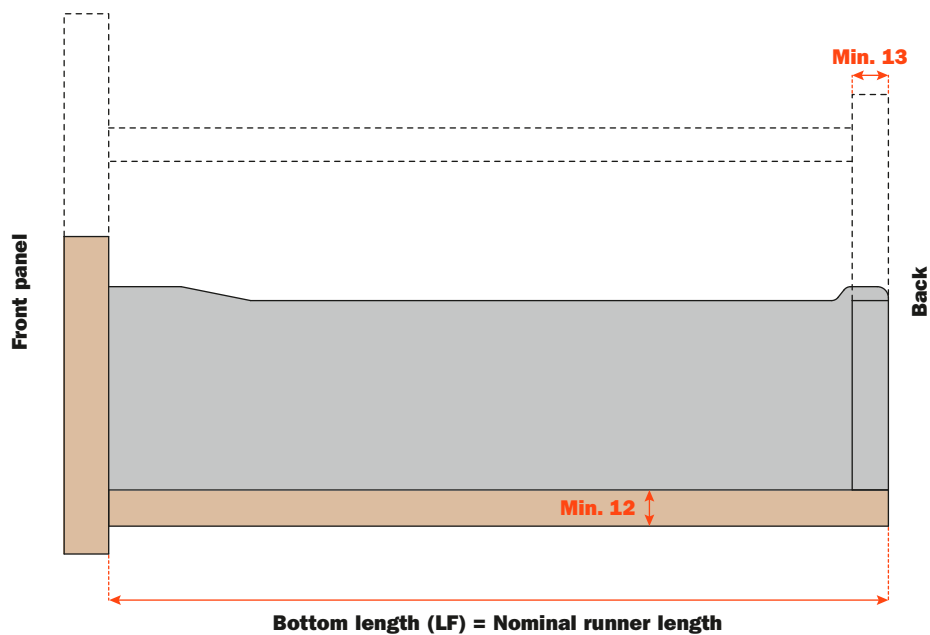

Metal sides fixing - h 85 mm

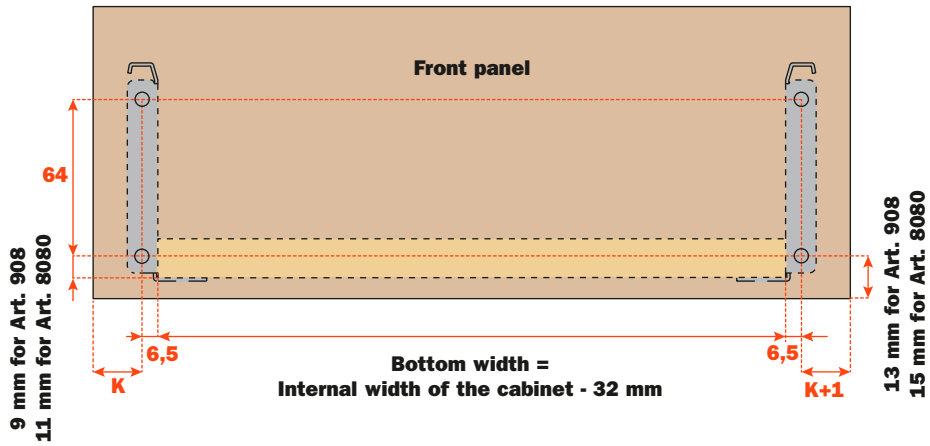

Fixing with dowels
ø 10x11 mm
for Rapid versions

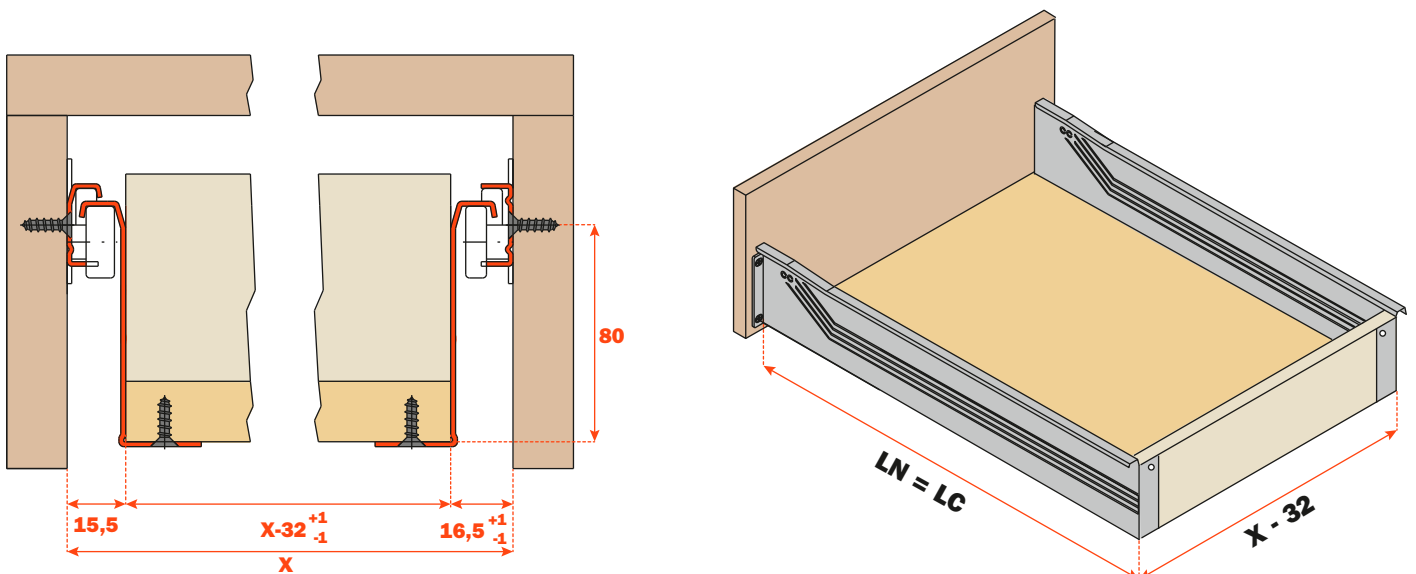
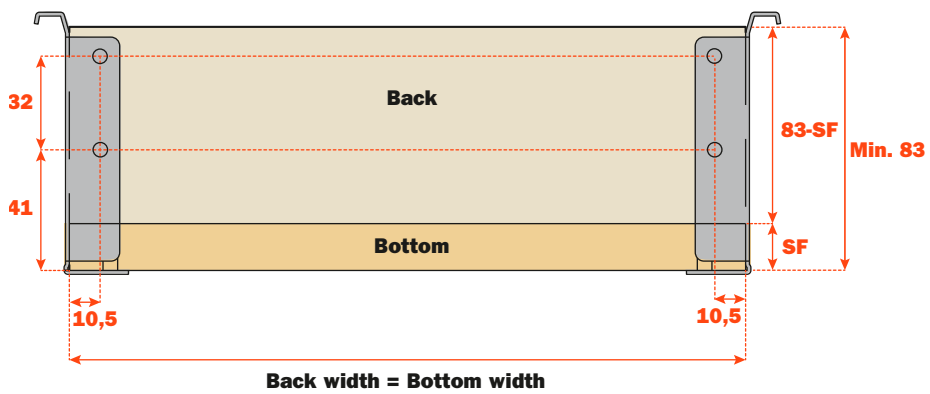

Art. 8000 - Metal sides fixing

Adapter fixing to front panel with screws.
For Series 8000.

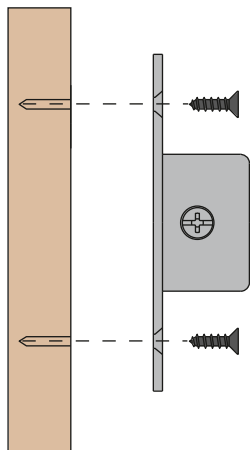

Adapter fixing to front panel with dowels.
For Series 8000 R.

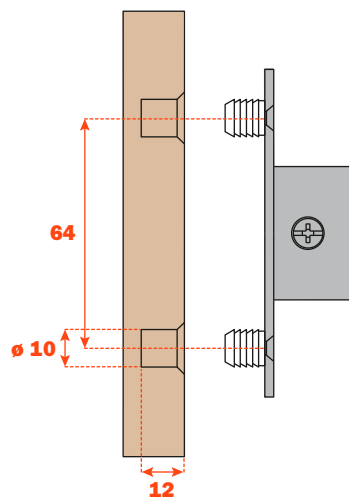

Metal sides fixing to the adapter.

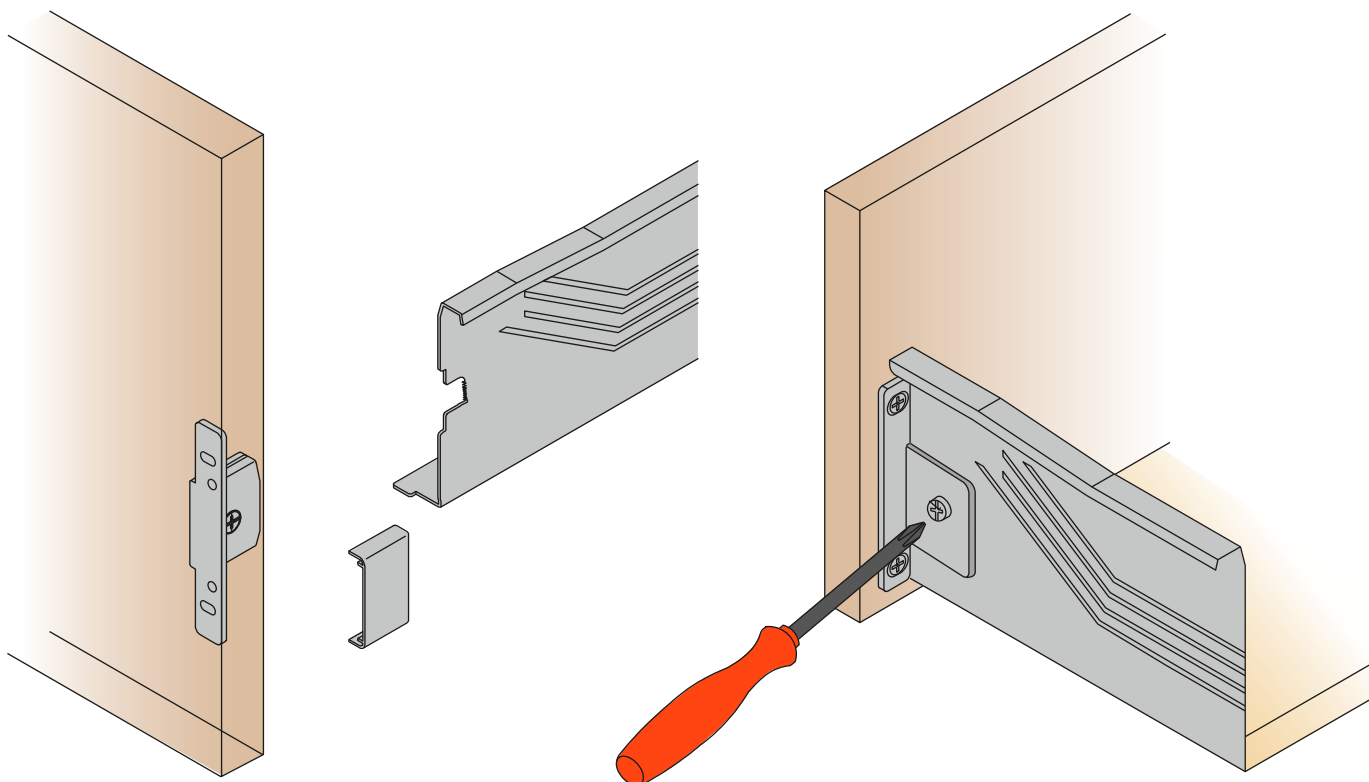

Adjustments for all articles Series 900 S/P and 900 R S/P

1) Vertical adjustment

Loosen screws A and adjust manually the frontal into the desired position of ± 2 mm. Finally the screws A must be retightened.

2) Lateral adjustment

Loosen screws A and adjust manually the frontal into the desired position of ± 1 mm. Finally the screws A must be retightened.

3) Tilt adjustment

The frontal tilt adjustment is possible only for rail system art. 409 R, by loosening and retightening the knurled dowel C of $\pm 1,5^\circ$.

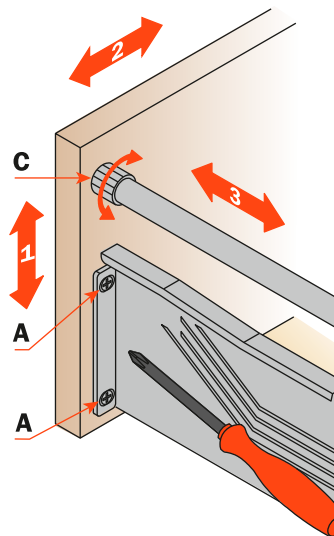

Adjustments for all articles Series 900

1) Vertical adjustment

Loosen screws A and adjust the frontal by rotating the cam adjuster B of $\pm 1,75$ mm. Finally the screws A must be retightened.

2) Lateral adjustment

Loosen screws A and adjust manually the frontal into the desired position of $\pm 1,5$ mm. Finally the screws A must be retightened.

3) Tilt adjustment

The frontal tilt adjustment is possible only for rail system art. 409 R, by loosening and retightening the knurled dowel C of $\pm 1,5^\circ$.

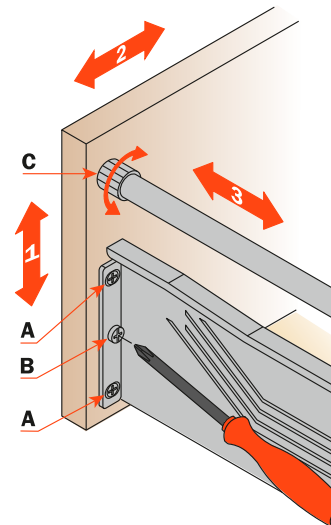

Adjustments for all articles Series 8000, 8000 R

1) Vertical adjustment

Loosen screw B and adjust manually the frontal into the desired position of $\pm 2,5$ mm. Finally the screw B must be retightened. At the end of the adjustment it is possible to apply a screw cover cap.

2) Lateral adjustment

Loosen screws A and adjust manually the frontal into the desired position of $\pm 1,75$ mm. Finally the screws A must be retightened.

3) Tilt adjustment

The frontal tilt adjustment is possible only for rail system art. 409 R, by loosening and retightening the knurled dowel C of $\pm 1,5^\circ$.

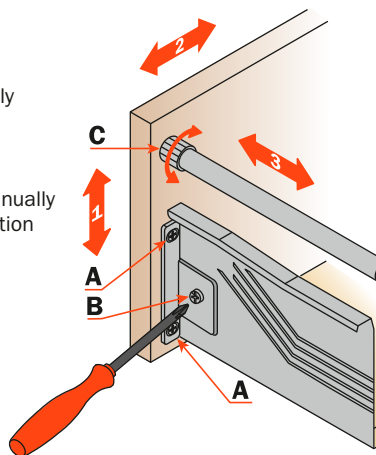

Self-Closing

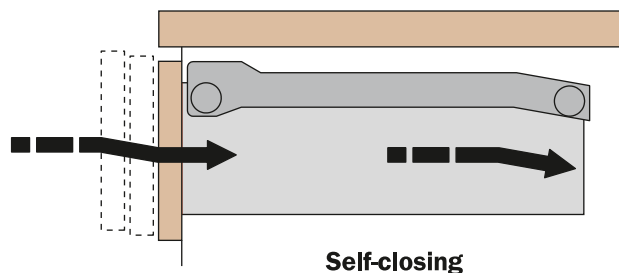

Extension

Runner length:

- up to 400 mm $\rightarrow x = \text{drawer length} - 80$ mm

- over 400 mm $\rightarrow x = \text{drawer length} - 100$ mm

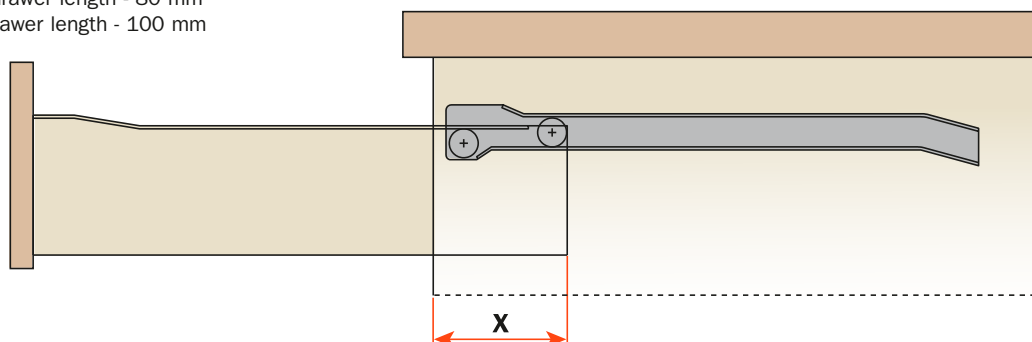



Product features

- Dimensions: 32 (± 1) mm.
- Left side captive (by pressure sliding) to ensure smooth opening and closing.
- Parallel exit during first 20 mm of pull-out (drawer does not rise).
- Bottom thickness: 12 ÷ 18 mm.
- Standard fixing of runner on cabinet side: screws TSP ø 3,5 mm, or EUROSREW.
- On request for knock-in assembly on cabinet side: 2 or 3 dowels ø 10x11 mm premounted on runner.
- Metal side fixing: screws TSP ø 3,5 or ø 3 mm.
- On request, for knock-in assembly on frontal: dowels ø 10x11 mm premounted on metal plate.
- Static load capacity N 294 (Kg 30).
- Dynamic load capacity N 245 (Kg 25).
- Double safety stop to prevent accidental pull-out of the drawer.
- Automatic closing during last 60 mm.
- Metal plate for frontal fixing: can be disassembled and adjusted.
- Special anti-interference profile for a perfect adherence between panels and metal sides (it is unnecessary to round off panels).
- Finish of metal plate for frontal: nickel-plated.

Dimensions - Assembly with screws and with dowels

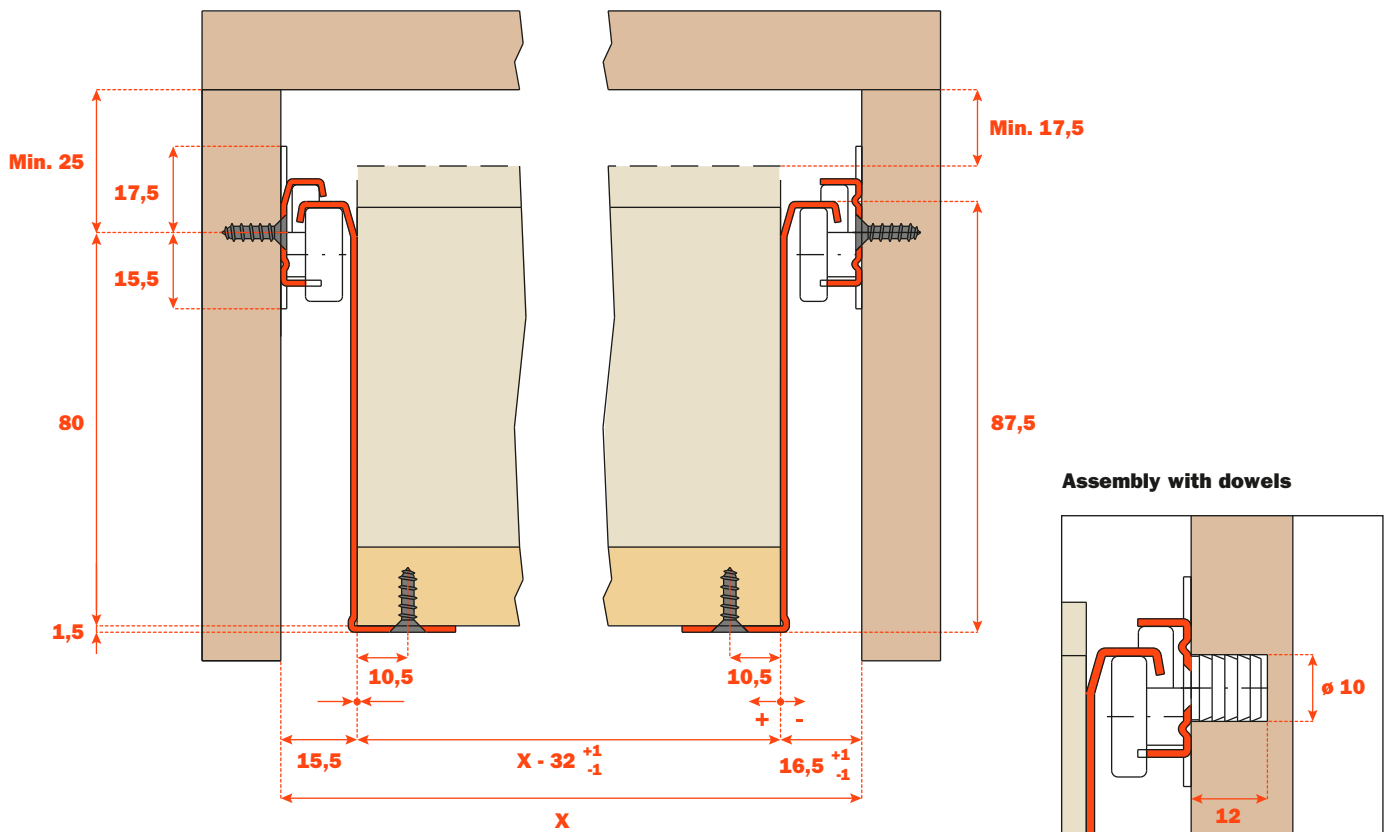

Part number for screw-on fixing runner on cabinet side

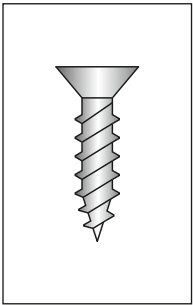

BASIC PART NUMBER
10 8080 0 280 _ _ _
10 8080 0 350 _ _ _
10 8080 0 400 _ _ _
10 8080 0 450 _ _ _
10 8080 0 500 _ _ _
10 8080 0 550 _ _ _

To be screw fixed
Screw TSP \varnothing 3,5 mm

Part number for knock-in fixing runner on cabinet side with 2 and 3 dowels

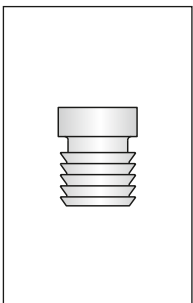

BASIC PART NUMBER 2 DOWELS	BASIC PART NUMBER 3 DOWELS
10 8080 0 280 _ _ _	
10 8080 0 350 _ _ _	
10 8080 0 400 _ _ _	
10 8080 0 450 _ _ _	10 8080 0 450 _ _ _
10 8080 0 500 _ _ _	10 8080 0 500 _ _ _
	10 8080 0 550 _ _ _

Knock-in
Drilling:
 \varnothing 10x11,5 mm

Use the table "Part number composition" at page 105 to complete the desired part number.