

## Push - Series B hinges



# Push - Series B hinges for glass doors

## Technical features

No drilling of the glass is required.  
Bright nickel plated die-cast cup and arm.

### Disclaimer

Salice Series B (CBG) hinges have been developed for use on glass doors and mirrors. Salice will accept no responsibility for any problems associated with the type of adhesive or method of application when used in conjunction with Series B hinges, nor for any consequences of the incorrect mounting of the door. It is recommended that the selected adhesive is subjected to prior testing.

The adhesive may be considered appropriate if the plate, when fixed to the glass, can sustain a minimum torsion load of 160 Nm.

Constant "L" value of 0.7 mm (it does not change during side adjustment).

Approx. number of hinges required according to the door dimension and weight.

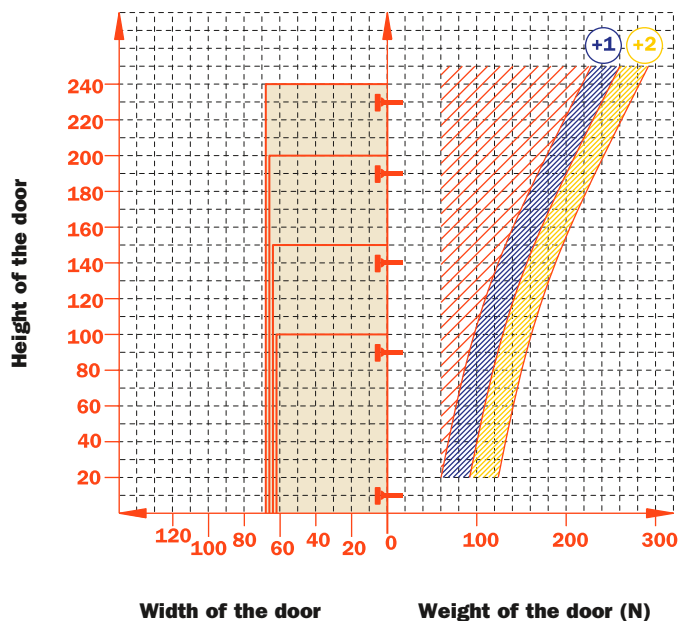

### Adjustments

Compensated side adjustment from -1.5 mm to +4.5 mm.  
Height adjustment  $\pm 2$  mm.  
Depth adjustment with Series 200 mounting plates +2.8 mm.  
Depth adjustment with Domi snap-on mounting plates from -0.5 mm to +2.8 mm.  
Anti-sliding safety stop.

### Mounting plates

Symmetrical and asymmetrical bright nickel plated steel or die-cast Series 200 mounting plates.  
Snap-on assembly on Domi mounting plates.  
Positioning with pre-determined stop on traditional Series 200 mounting plates.

N.B. : Use POZIDRIVE No. 2 screwdrivers for all screws.

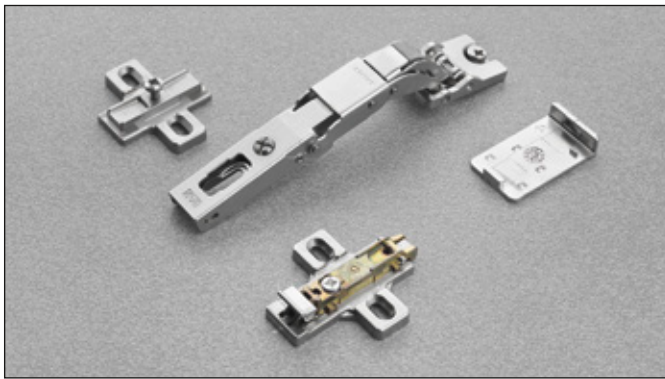

**Technical information**

**Push hinges are equipped with a special spring that acts to open the door independently of the release device.**

Hinge for glass doors. No drilling of the glass is required. Possible fixing inset distance on the door (K): from 0 to 22 mm. 110° opening. Compatible with all traditional Series 200 mounting plates and with all Domi snap-on mounting plates.

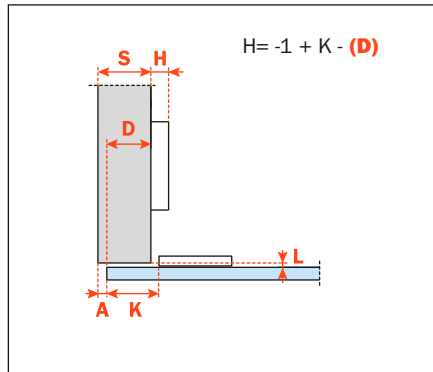
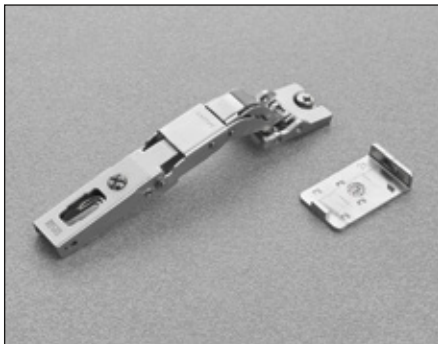

**CBGQA99**

**Packing**  
Boxes 150 pcs.  
Pallets 3.600 pcs.

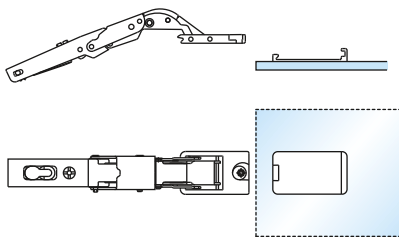

**1)** The hinge plate must be attached to the glass door or mirror by a special adhesive. We recommend that this operation is carried out by a specialist company. For further information on adhesives and their application, please contact the adhesive manufacturer or your glass supplier.

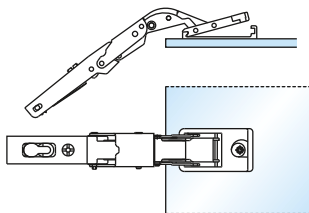

**2)** Fix the hinge when the plate is bonded to the glass.

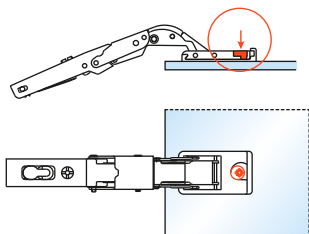

**3)** Locate the hinge cup onto the plate and rotate the cam.

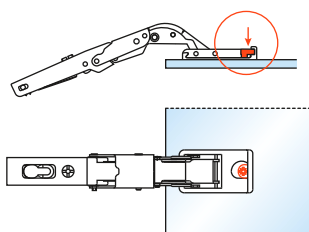

**4)** The hinge is now fixed to the door.

**“C” Value**

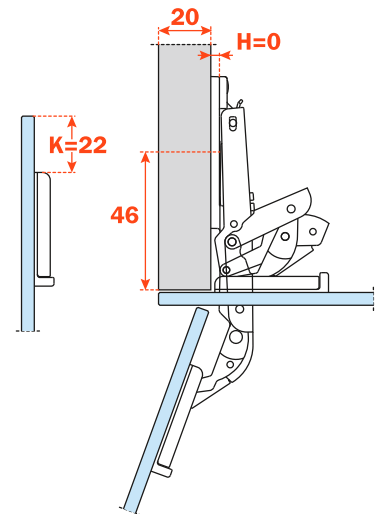

$K = 0 - 22$

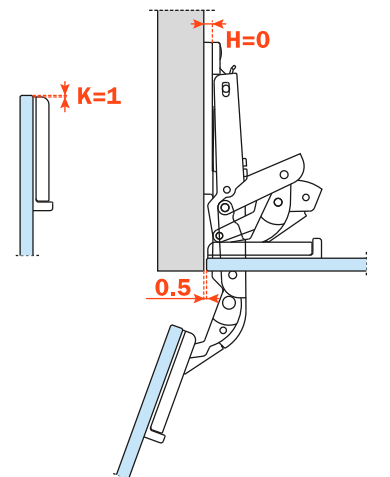

## Push - Series B hinges for wooden doors

### Technical features

Series B hinges can provide a solution to a number of special applications, which include half-inset doors and doors with moulded profiles  
**Dimensions of the 35 mm cup.**  
**Bright nickel plated die-cast cup and arm.**

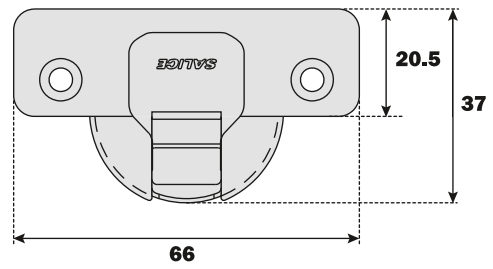

Constant "L" value of 0.7 mm (it does not change during side adjustment).

Approx. number of hinges required according to the door dimension and weight.

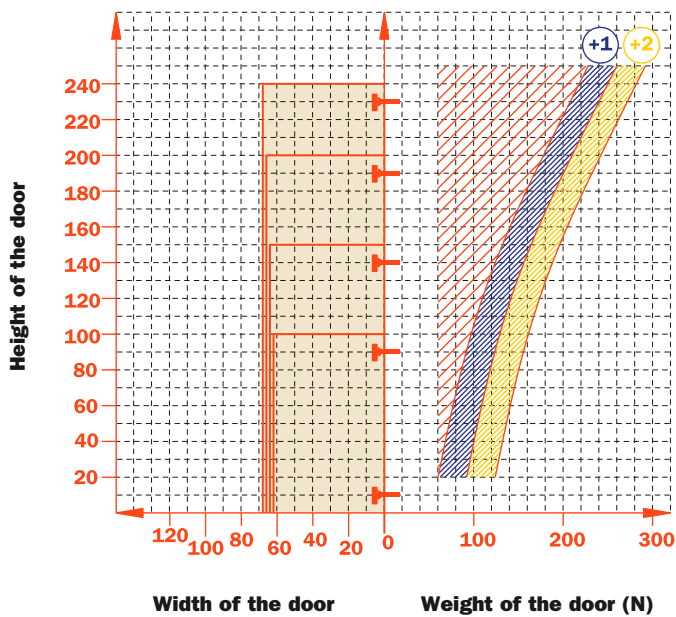

### Adjustments

Compensated side adjustment from -1.5 mm to +4.5 mm.  
 Height adjustment  $\pm 2$  mm.  
 Depth adjustment with Series 200 mounting plates +2.8 mm.  
 Depth adjustment with Domi snap-on mounting plates from -0.5 mm to +2.8 mm.  
 Anti-sliding safety stop.

### Mounting plates

Symmetrical and asymmetrical bright nickel plated steel or die-cast Series 200 mounting plates.  
 Snap-on assembly on Domi mounting plates.  
 Positioning with pre-determined stop on traditional Series 200 mounting plates.

N.B. : Use POZIDRIVE No. 2 screwdrivers for all screws.

	<p>48  <math>\varnothing 35</math>          6  <b>110°</b></p>	<p>45  <math>\varnothing 35</math>          9.5  <b>110°</b></p>	<p>52  <math>\varnothing 35</math>          5.5  <b>110°</b></p>
<p><b>Wood screw</b></p>	<b>A</b>	<b>P</b>	<b>U</b>
	<p>48  <math>\varnothing 35</math>  <math>\varnothing 10</math>          6  <b>110°</b></p>	<p>45  <math>\varnothing 35</math>  <math>\varnothing 8</math>          9.5  <b>110°</b></p>	<p>52  <math>\varnothing 35</math>  <math>\varnothing 10</math>          5.5  <b>110°</b></p>
<p><b>Dowel</b></p>	<b>B</b>	<b>R</b>	<b>W</b>

**Use this table to identify the available drillings and fixings.  
 Fill the third position of the hinge code number with the letter or the number  
 corresponding to your choice. I.e.: CB\_QA99.**

↑  
 Fill this position with the chosen letter or number.

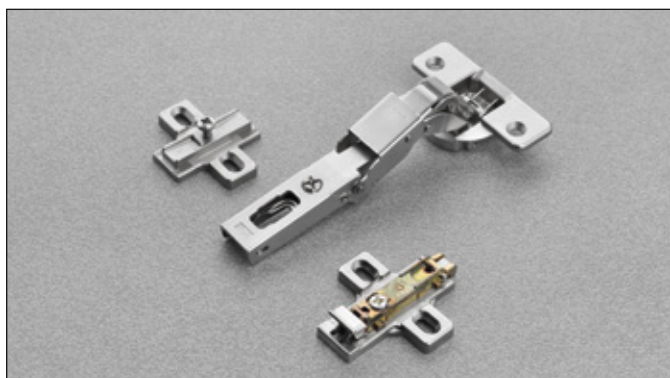

**Technical information**

**Push hinges are equipped with a special spring that acts to open the door independently of the release device and can provide a solution to a number of special applications, which include half-inset doors and doors with moulded profiles**

9 mm deep metal cup.  
 110° opening.  
 Possible drilling distance on the door (K): from 3 to 18 mm.  
 Compatible with all traditional Series 200 mounting plates and with all Domi snap-on mounting plates.

**Space needed to open the door**

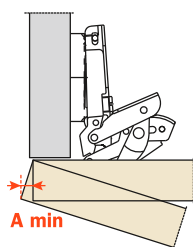

	T=	16	18	20	22	24	26
K=3	<b>A=</b>	0.0	0.0	0.0	0.0	0.3	1.4
K=4	<b>A=</b>	0.0	0.0	0.0	0.0	0.4	1.5
K=5	<b>A=</b>	0.0	0.0	0.0	0.0	0.5	1.9
K=6	<b>A=</b>	0.0	0.0	0.0	0.0	0.7	2.6
K=7	<b>A=</b>	0.0	0.0	0.0	0.0	11.3	12.8
K=8	<b>A=</b>	0.0	0.0	0.0	0.0	10.3	12.9
K=9	<b>A=</b>	0.0	0.0	0.0	0.0	9.3	11.9
K=10	<b>A=</b>	0.0	0.0	0.0	6.0	8.3	10.9
K=11	<b>A=</b>	0.0	0.0	0.0	5.1	7.3	9.9
K=12	<b>A=</b>	0.0	0.0	0.0	4.1	6.3	8.9
K=13	<b>A=</b>	0.0	0.0	1.4	3.3	5.3	7.9
K=14	<b>A=</b>	0.0	0.0	0.7	2.6	4.5	6.9
K=15	<b>A=</b>	0.0	0.0	0.2	2.0	3.8	5.9
K=16	<b>A=</b>	0.0	0.0	0.0	1.4	3.2	5.0
K=17	<b>A=</b>	0.0	0.0	0.0	1.0	2.7	4.4
K=18	<b>A=</b>	0.0	0.0	0.0	0.7	2.2	3.9

**The above values are calculated on the assumption that the doors have square edges. They are reduced if the doors have radiussed edges.**

**Projection of the door**

Projection of the door from the cabinet side at the max. opening. The figures are based on a straight arm hinge, H=0 mm thickness of mounting plate and K value = 3 mm.

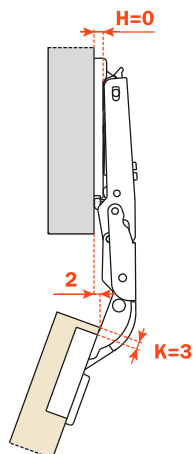

**“C” value**

With this formula you can obtain the max. thickness of the moulded door that can be opened without touching adjacent carcass sides, doors or walls, whilst bearing in mind the above L-K-T values.

$$C = 5.5 + K + A$$

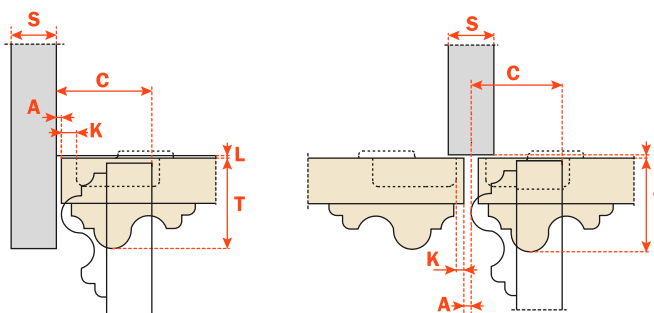



**Packing**

Boxes 150 pcs.  
Pallets 3.600 pcs.

Use these formulas to determine the type of hinge arm, the drilling distance "K" and the height of the mounting plate "H" which is necessary to solve each application problem.

To limit the opening of the hinge, see page 354 chapter "Accessories".

Use the tables "Drillings and fixings" at page 231 to complete the code number of the desired hinge.

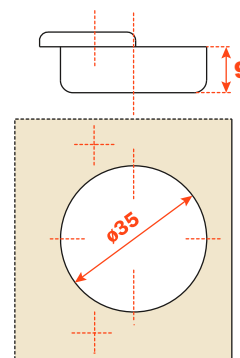

Arm 0

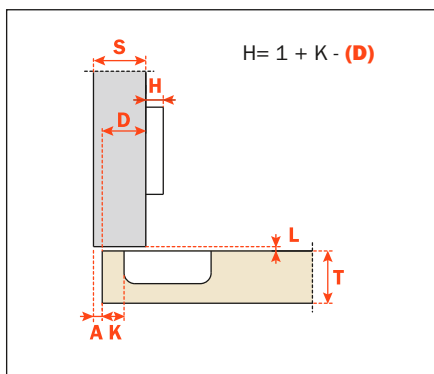
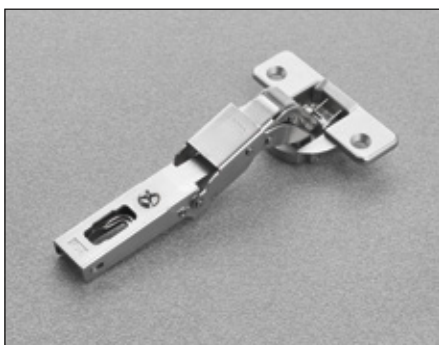

**CB\_QA99**

